

ALL DRAWN AND WRITTEN INFORMATION APPEARS HEREON SHALL NOT BE DUPLICATED, REPRODUCED, OR OTHERWISE USED WITHOUT THE WRITTEN CONSENT OF DEVELOPMENT SERVICES, INC.

PRINT RECORD		DATE
PURPOSE		

REVISION RECORD		
NO.	CHANGE	DATE
ES	CONCEPTUAL	08/25/18

DRAWN	SWG
CHECKED	SWG
DATE	05/10/18
SHEET TITLE	CONCEPTUAL SITE PLAN

REALM REALTY



900 Texas & Country Lakes Suite 210 Houma, Texas 77728 (713) 445-0001

SHEET	SP-1	OF	TOTAL
-------	------	----	-------

SHOPPING CENTER DEVELOPMENT SUMMARY					
TENANT	TENANT DESCRIPTION	BUILDING AREA	RATIO	PARKING REQ'D	PARKING
	AVAILABLE	24,701 SF	1/200	124	124
	CLUB 4 FITNESS	27,805 SF	1/200	139	139
A	SALAD STATION	2,062 SF	1/100	20	20
B	CPL LABS	1,440 SF	1/200	7	7
C	AVAILABLE	2,700 SF	1/250	11	11
D	CAJUN TABLE	1,800 SF	1/100	18	18
E	NEW YORK BAGEL	2,250 SF	1/100	23	23
F	CICI'S PIZZA	4,050 SF	1/250	16	16
H	WASABI RESTAURANT	4,500 SF	1/100	45	45
I	WORLD NAILS	1,350 SF	1/250	6	6
J-K	ROYAL CURRY	2,700 SF	1/100	27	27
L	FAST FRAMES	1,350 SF	1/250	6	6
	DOLLAR TREE	12,430 SF	1/250	50	50
LOT 5	PROPOSED RESTAURANT	4,690 SF	1/100	47	6
	-- PARKING PROVIDED ON LOT 1A				41
	SURPLUS PARKING SPACES				5
TOTAL	ALL TENANTS	94,540 SF		545	550

LOT 1A LAND AREA 496,979 SF
 OPEN SPACE REQUIRED (20%) 99,698 SF
 OPEN SPACE PROVIDED 99,946 SF

LOT 5 LAND AREA 23,428 SF
 OPEN SPACE REQUIRED (25%) 5,857 SF
 OPEN SPACE PROVIDED 8,873 SF

NON-FITNESS PARKING AREA

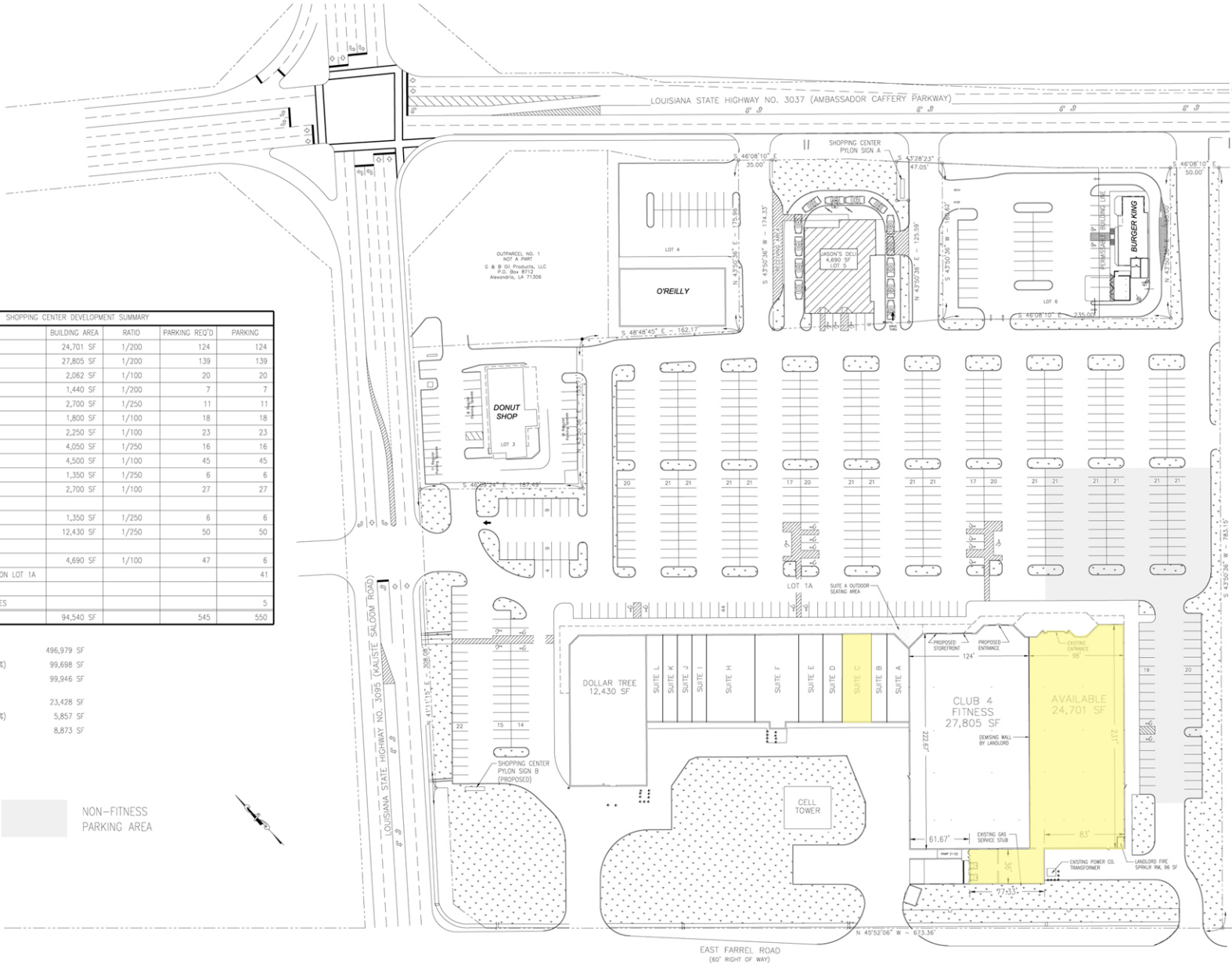

1 CONCEPTUAL SITE PLAN
 SCALE: 1" = 50'-0" (22x34) or 1" = 100' (11x17)

VER. ES