

SITE DATA	
PARCEL 1 LAND AREA:	6,270 SF
PARCEL 2 LAND AREA:	60,379 SF
PARCEL 3 LAND AREA:	21,275 SF
BILLBOARD #1 LAND AREA:	1,213 SF
BILLBOARD #2 LAND AREA:	600 SF
TOTAL LAND AREA:	89,737 SF

BUILDING DATA	
PROPOSED BUILDING AREAS:	
RETAIL	= 4,800 SF
BERACA AUTO	= 1,019 SF
TOTAL	= 5,819 SF

PARKING DATA	
PARKING REQUIRED: AS REQUIRED BY APPLICABLE CODES	
PARKING AVAILABLE:	
RETAIL	20 SPACES
PARKING RATIO:	4.17/1000 SF GLA
BERACA AUTO	12 SPACES
PARKING RATIO:	11.78/1000 SF GLA
TOTAL PARKING	32 SPACES
PARKING RATIO:	5.5/1000 SF GLA

ACCESSIBLE PARKING DATA	
PARKING REQUIRED: AS REQUIRED BY APPLICABLE CODES	
PARKING PROVIDED:	
2	STD HANDICAPPED ACCESSIBLE
3	VAN HANDICAPPED ACCESSIBLE

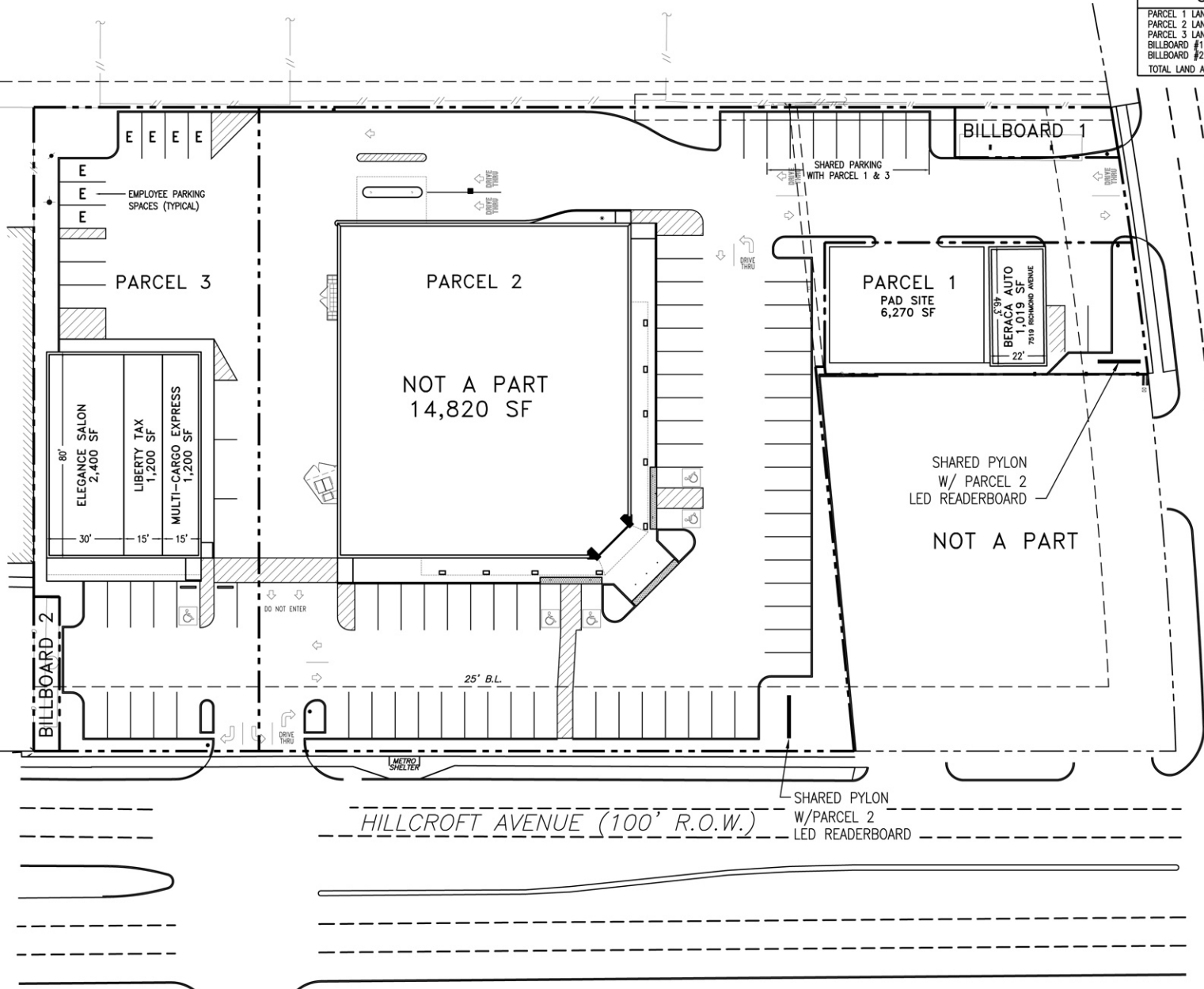

PARKING IS PERMITTED ON PARCEL 3 AND THE "SHARED PARKING" LOCATED ON PARCEL 2 PER THIS SITE PLAN EXHIBIT

**DEVELOPMENT SERVICES INCORPORATED**  
 900 Town & Country Lane, Suite 220, Houston, Texas 77024, (713) 442-2811

**RICHMOND - HILLCROFT SC**  
**RICHMOND & HILLCROFT HOUSTON, TEXAS**  
 Richmond-Hilcroft, Retail, L.P.  
 900 Town & Country Ln, Ste 210 Houston, TX 77024

NO:	1	LEASE EXHIBIT
ISSUE:		
DATE:	08/10/17	

DRAWN:	SAS
CHECKED:	SWG
DATE:	04/26/04
SHEET TITLE:	EXHIBIT SITE PLAN
<small>ALL DRAWING AND WRITTEN INFORMATION APPLICABLE HEREIN SHALL NOT BE REPRODUCED, COPIED, OR OTHERWISE USED WITHOUT THE WRITTEN CONSENT OF DEVELOPMENT SERVICES, INC.</small>	

SHEET  
**SP-11**

BEVERLY HILL ST.

NORTH

1 SITE DIMENSIONAL PLAN  
 SCALE: 1" = 20' (22x34) OR 1" = 40' (11x17)